



TUBE CLAMPS



EASY TO USE

Tubeclamp fittings are manufactured with simplicity and ease of use very much in mind. No special skills are required - no welding, no bending, no threading, just an Allen key to tighten the set screws and you can join tubing together in a matter of seconds. The comprehensive range of fittings and sizes means Tubeclamps can be used in a wide variety of applications, temporary or permanent.

For example in the construction of -

- | | |
|---------------------------|---------------------------|
| Handrails | Market Stalls |
| Safety Barriers | Exhibition Stands |
| Awnings | Temporary Buildings |
| Support Structures | Lighting Grids |
| Children's Play Equipment | Pallet or Garment Racking |

EASY TO ORDER

As with the fittings we've also made ordering simple. Each illustration in this manual carries a number - for example 101. Look under the type column and you will see that this fitting is available in five different sizes ABCDE. Each of these letters refers to the size of the tube on which the fitting is to be used as indicated below. No letter after the fitting number indicates that size is not available at the time of printing.

For example 191 is only available to suit size D tubing.

GALVANISED TUBE IN LENGTHS OF APPROX. 6.5 METRES

ALSO AVAILABLE IN 3, 2 AND 1.075 METRE LENGTHS

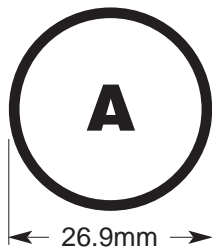

CODE: 160225

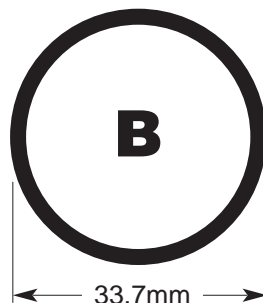

CODE: 160234

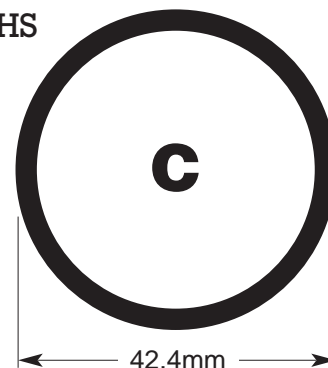

CODE: 160242

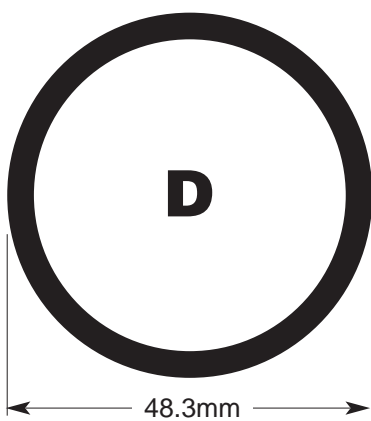

CODE: 160248

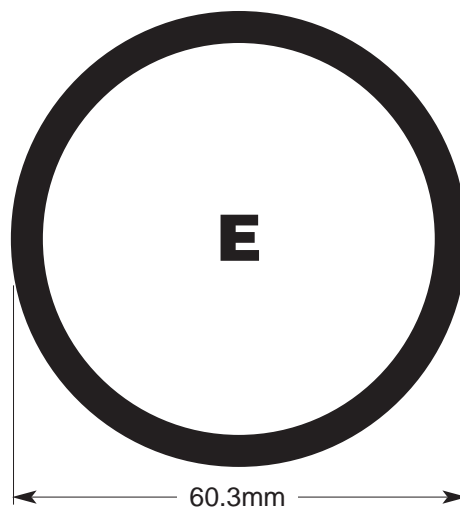

CODE: 160260

IMPERIAL SIZES	
TUBE DIA. MM O/D	TUBE DIA. INCHES O/D
A 26.9	1.1/16"
B 33.7	1.11/32"
C 42.4	1.11/16"
D 48.3	1.29/32"
E 60.3	2.3/8"

NOTE: The standard finish is hot-dipped galvanised.

Tubeclamps are also available in self-colour condition (as cast), epoxy or polyester powder coated, in a range of colours.

Whilst every care has been taken to ensure that the information given in this manual is correct, F.H.Brundle reserve the right to alter and revise this information as and when they consider it necessary. This is in line with their policy of research and development.



101

Short Tee

A
B
C
D
E



128

3 Way 90° Elbow

A
B
C
D
E



138

Gate Eye

A
B
C
D



149

Sleeve Joint

A
B
C
D
E



104

Long Tee

A
B
C
D
E



129

Adjustable Short Tee
30° - 60°

B
C
D



140

Gate Hinge

A
B
C
D



150

Internal Joint

B
C
D



116

Corner
with through centre tube

A
B
C
D
E



130

Two Socket Cross
with adjustable centre 30° - 45°

B
C
D



143

Handrail Bracket

A
B
C
D



152

Base Flange
allows slope up to 11°

D



119

Two Socket Cross
with centre vertical tube

A
B
C
D
E



131

Wall Flange

A
B
C
D
E



144

Railing Side Support
vertical base

B
C
D



153

Short Tee
allows slope up to 11°

D



124

Variable Elbow
15° - 16° from horizontal

B
C
D



132

Railing Base Flange

A
B
C
D
E



145

Railing Side Support
horizontal base

B



154

Elbow
allows slope up to 11°

D



125

90° Elbow

A
B
C
D
E



133

Stop Ends (plastic)

A
B
C
D
E



146

Side Palm Fixing

B
C
D



155

Long Tee
allows slope up to 11°

D

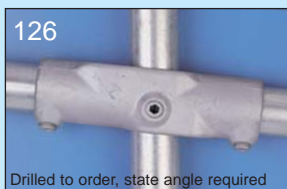

126

Angle Cross
for slope up to 45°

B
C
D



134

Ground Socket

B
C
D



147

Internal Swivel Tee

B
C
D



156

Two Socket Cross
allows slope up to 11°

D

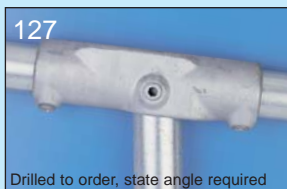

127

Angle Tee
for slope up to 45°

B
C
D



135

Clamp on Tee

A
B
C
D
E



148

Short Tee Swivel
Used in pairs

A
B
C
D
E



158

Four Way Cross
with centre tube

A
B
C
D
E



160

Clamp on Crossover

A
B
C
D
E



168M

90° Corner Swivel Male Section

A
B
C
D



173M

Single Male Section of Swivel

A
B
C
D
E



191

27 1/2° Ridge Fitting

D



161

90° Crossover
Also available in C/B, D/C, D/B

A
B
C
D
E



169

Swivel Base

A
B
C
D
E



173

Single Swivel Combination

A
B
C
D
E



192

Base Flange Weather Shield

B
C
D



165

Combination Socket tee and crossover

A
B
C
D
E



169M

Swivel Base Section

A
B
C
D
E



176

Side Outlet Tee

A
B
C
D
E



199

Adjustable Fixing Bracket

C
D



167

Double Swivel Combination

A
B
C
D
E



170

Mesh Panel Clip (single)

A
B
C
D
E



179

Locking Collar

A
B
C
D
E



B53

Inline Swivel Fitting

D



167M

Double Male Section of Swivel

A
B
C
D
E



171

Mesh Panel Clip (double)

A
B
C
D
E



182

Hook

A
B
C
D
E



232

Screw and Allen Key

A
B
C
D
E



168

90° Corner Swivel Combination

A
B
C
D



173F

Female Section of Swivel

A
B
C
D
E



185

27 1/2° Eaves Fitting

D

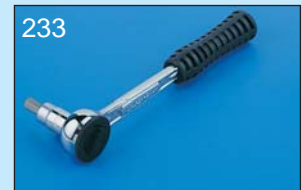

233

Ratchet Set

A
B
C
D
E

SLOPE FITTINGS

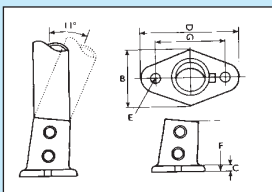

152D BASE FLANGE
UPRIGHT PIVOTS
UP TO 11° FROM
VERTICAL

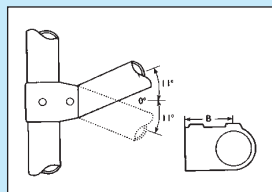

153D SHORT TEE
JOINS MIDDLE
RAIL TO END
UPRIGHTS ON
SLOPES UP TO 11°

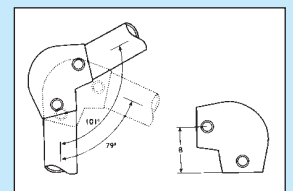

154D ELBOW
JOINS TOP RAIL TO END
UPRIGHTS ON SLOPES
UP TO 11°

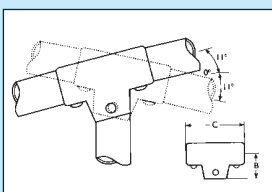

155D LONG TEE
JOINS INTERMEDIATE
UPRIGHTS TO TOP
RAIL ON SLOPES UP
TO 11°. ALSO ACTS AS
A SLEEVE JOINT

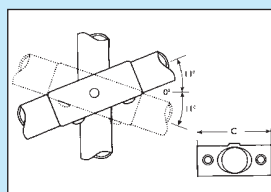

**156D TWO SOCKET
CROSS**
JOINS INTERMEDIATE
UPRIGHTS TO MIDDLE
RAIL ON SLOPES UP TO
11°. UPRIGHT PASSING
THROUGH THE FITTING

TUBECLAMP GUARD RAIL FITTINGS AND FIXINGS

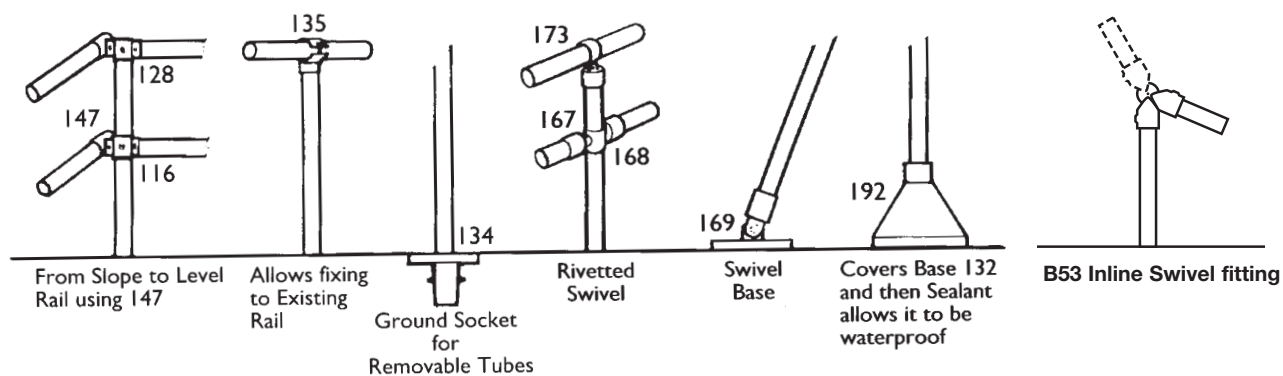
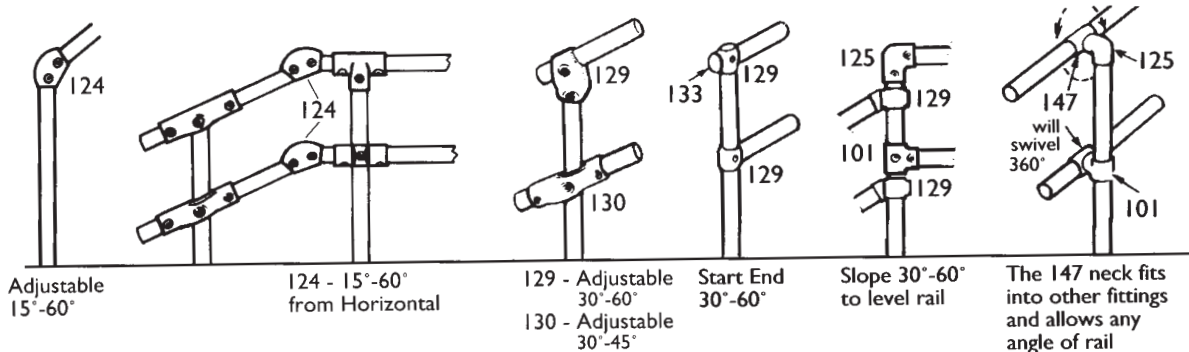
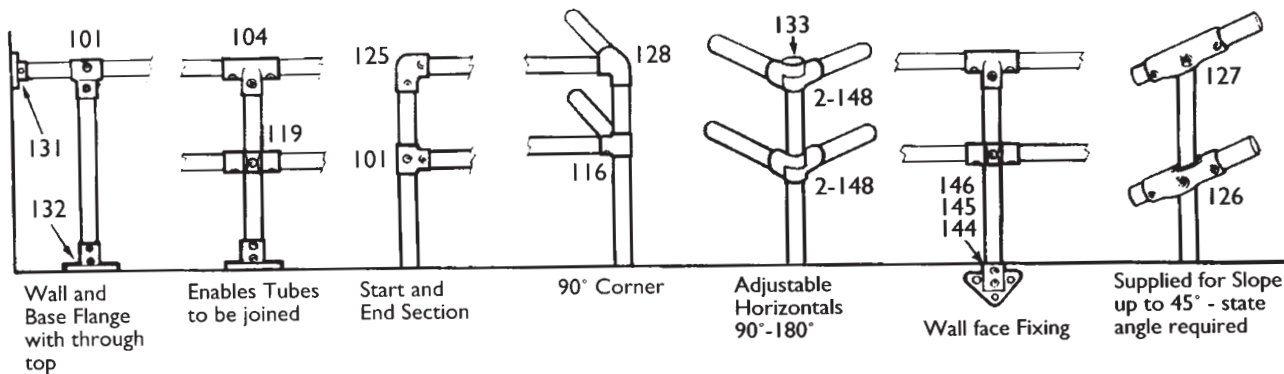

Gradient Fittings

For railings required on slopes and ramps between 0-11 degrees

Available to suit 48.3mm O.D. tube (D Size)

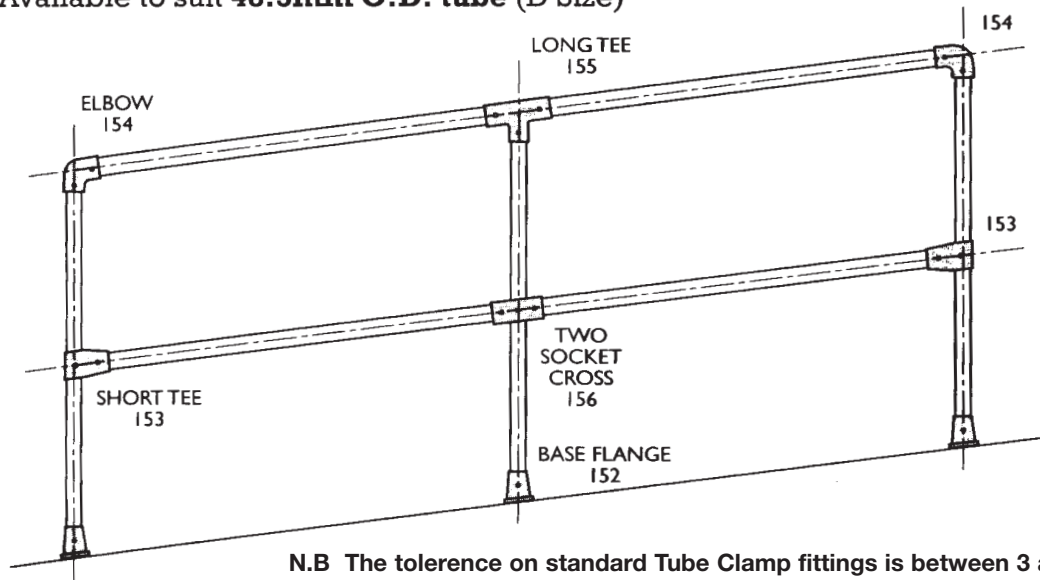

N.B The tolerance on standard Tube Clamp fittings is between 3 and 5 degrees

MILD STEEL DISCS

DIAMETER	1.5mm	3.0mm	5.0mm	6.0mm
CODE NUMBER INDICATES STOCK SIZE				
1"	20115	2013	x	x
1½"	201515	20153	20155	20156
2"	20215	2023	2025	2026
2½"	202515	20253	20255	20256
3"	20315	2033	2035	2036
3½"	203515	20353	20355	20356
4"	20415	2043	2045	2046
5"	20515	2053	x	2056
6"	20615	2063	x	2066

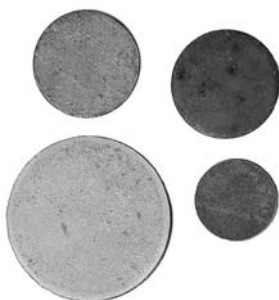

HANDRAIL BRACKETS



CODE 171161
57mm Electro-Galvanised



CODE 171162
80mm Self Colour with Cover Plate

OTHER SIZES MAY BE IN STOCK, PLEASE ENQUIRE

PALLET FEET

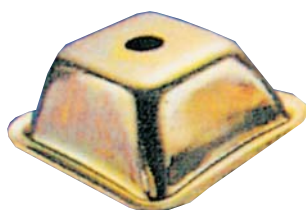

 2½" 56mm 2½" 54mm 1" 25mm 5" sq 127mm	 2½" 64mm 2½" 51mm 1" 25mm 5" sq 127mm	 3" 76mm 2½" 51mm 1" 25mm 6½" sq 166mm	 1½" 48mm 1½" 38mm 3½" sq 89mm
26F1A 13G (2.34mm)	26F1C	26F2 (3.00mm)	26F3 13G (2.34mm)

PAINT



HIGH BUILD VINYL, BLACK 5 LITRES CODE 2900
RED OXIDE, 5 LITRES CODE 2904
ZINC SPRAY, 500ml CODE 2902

HANDRAIL STANDARDS

LOADINGS

This table represents our maximum recommended pitch for each size of standard.

Based upon 1100mm high standards

HANDRAILING DIAMETER mm	33.7 O.D	42.4 O.D	48.3 O.D	33.7 O.D	42.4 O.D
	SHANK DIAMETER mm	33.7 O.D	42.4 O.D	48.3 O.D	42.4 O.D
220 N/M	1455	2000	2000	2000	2000
360 N/M	889	1417	2000	1417	2000
740 N/M	432	689	973	689	973

MAX RECOMMENDED SPACING 2000mm

OPEN STEEL FLOORING BAR SIZE SELECTOR

The tables below are an easy guide to enable you to chose the most appropriate bar size to achieve the three catagories of loading specified in BS4592.

The tabulated figures are in mm and represent the maximum unsupported span for each load bar.

LOAD BEARING BARS AT 41mm PITCH - W100

		20 x 3	20 x 5	25 x 3	25 x 5	30 x 3	30 x 5	35 x 3	35 x 5	40 x 3	40 x 5	45 x 5	50 x 5	55 x 5	60 x 5
LIGHT DUTY	3.0 KN/M²	1104	1308	1379	1636	1655	1952	1931	2214	2155	2446	2673	2892	3108	3317
GENERAL DUTY	5.0 KN/M²	935	1103	1164	1379	1396	1655	1629	1931	1861	2154	2353	2546	2735	2919
HEAVY DUTY	7.5 KN/M²	815	964	1017	1204	1220	1446	1423	1687	1626	1928	2126	2301	2471	2638

LIGHT DUTY - Access limited to 1 person **GENERAL DUTY** - Regular pedestrian traffic **HEAVY DUTY** - High density traffic

LOAD BEARING BARS AT 30mm PITCH - N100

		20 x 3	20 x 5	25 x 3	25 x 5	30 x 3	30 x 5	35 x 3	35 x 5	40 x 3	40 x 5	45 x 5	50 x 5	55 x 5	60 x 5
LIGHT DUTY	3.0 KN/M²	1223	1449	1528	1802	1834	2110	2104	2391	2326	2643	2887	3124	3355	3581
GENERAL DUTY	5.0 KN/M²	1031	1223	1289	1529	1547	1834	1805	2104	2047	2326	2541	2750	2953	3152
HEAVY DUTY	7.5 KN/M²	901	1068	1126	1335	1351	1602	1577	1869	1802	2103	2295	2485	2668	2849

LIGHT DUTY - Access limited to 1 person **GENERAL DUTY** - Regular pedestrian traffic **HEAVY DUTY** - High density traffic